

SITE EXTENT (AS PER PLAN) : 2319 SQ.M
ROAD AREA : 560 SQ.M
NO.OF.PLOTS : 8 Nos.

NOTE :

1. MEASUREMENTS ARE INDICATED EXCLUDING SPLAY DIMENSION.
2. ROAD AREA WAS HANDED OVER TO THE LOCAL BODY VIDE GIFT DEED DOCUMENT NO.17679/2019, DATED;16.12.2019, @ SRO AVADI.

CONDITIONS:

TNCDBR-2019, RULE NO : 47 (11)

THE COST OF LAYING IMPROVEMENTS TO THE SYSTEMS IN RESPECT OF ROAD, WATER SUPPLY, SEWERAGE, DRAINAGE OR ELECTRIC POWER SUPPLY THAT MAY BE REQUIRED AS ASSESSED BY THE CONCERNED AUTHORITY,NAMELY,THE LOCAL BODY AND TAMIL NADU ELECTRICITY BOARD, SHALL BE BORNE BY THE APPLICANT

©NECESSARY SPACE FOR BUILDING LINE TO BE LEFT AS PER THE RULE IN FORCE WHILE TAKING UP DEVELOPMENT IN EVERY PLOT.

LEGEND :

- ▬ SITE BOUNDARY
- ▬ ROADS GIFTED TO LOCAL BODY
- ▬ EXISTING ROAD

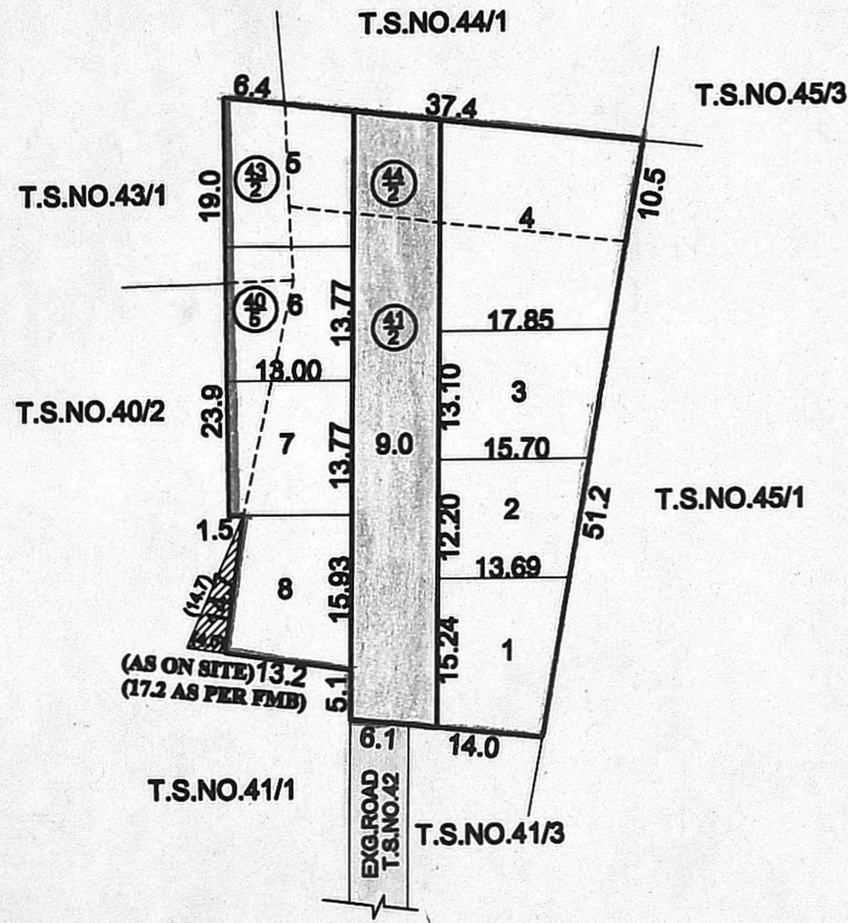

CONDITION:

THE SUB-DIVISION APPROVED IS VALID SUBJECT TO OBTAINING SANCTION FROM THE LOCAL BODY CONCERNED.

P.P.D NO: 137
L.O 2019

APPROVED

VIDE LETTER NO : L1/16008/2019

DATE : 31/12/2019

14/2
31/12/19
FOR CHIEF PLANNER (MSB/LAYOUT)
CHENNAI METROPOLITAN
DEVELOPMENT AUTHORITY

S. Anura
PREPARED BY
30/12/19

P.A.I
P.A.I

AP
AP

AVADI MUNICIPAL CORPORATION
SUB-DIVISION OF HOUSE SITES IN (OLD S.Nos. 193/1pt,2pt, 5-1, 5-2) PRESENT T.S.Nos. 40/5,41/2,43/2 AND S.No.44/2, WARD-A, BLOCK NO.9 OF MITTANAMALLI VILLAGE.

SCALE-1:800 (ALL MEASUREMENTS ARE IN METRE)

